

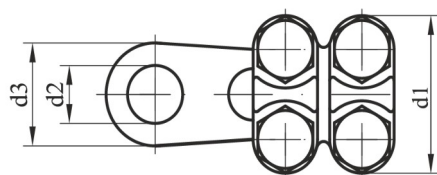

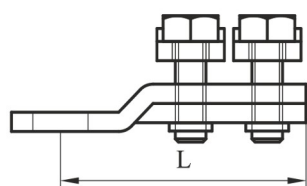



CODE: D40110x (x=5 to 10)
Item: Copper cable lugs clamping type

PRODUCT TECHNICAL SPECIFICATION

Description: Copper cable lugs clamping type are designed for connecting copper conductors to copper busbars of distribution networks up to 1kV.



No.	Cable cross-section (mm ²)	Code	Type	Dimensions (mm)				Bolt	Packing				Barcode
				d1	d2	d3	L		Product weight (g)	Bag packing (pcs)	Box packing (pcs)	Box BRUTO weight (kg)	
1	35	D40-11-05	VKP 35	27	8,5	20	37	M5x12	27,30	50	500	14,14	 8605031000917
2	50	D40-11-06	VKP 50	28	10,5	20	46	M5x12	39,55	50	500	20,27	 8605031000924
3	70	D40-11-07	VKP 70	30	10,5	20	52	M5x12	48,40	50	500	24,69	 8605031000931
4	95	D40-11-08	VKP 95	32	13	24	57	M6x20	77,33	25	250	19,83	 8605031000948
5	120	D40-11-09	VKP 120	40	13	24	60	M8x20	124,96	25	250	31,73	 8605031000955
6	150	D40-11-10	VKP 150	42	13	30	65	M8x20	147,00	25	100	15,19	 8605031000962

Other characteristics

Body material: Copper alloy galvanized
Required tools: Wrench of appropriate size
Marking: Plamen, VKP, cable cross-section
Standard: DIN 46227

