

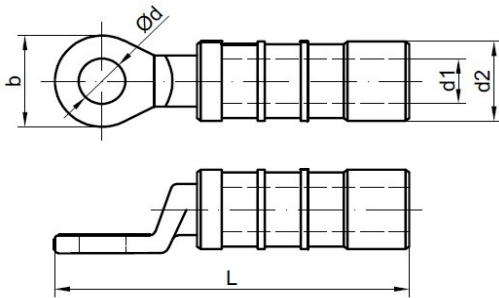









CODE: P4058xx
Item: Preinsulated tin-coated aluminum lugs CPTAR

PRODUCT TECHNICAL SPECIFICATION

Description: Preinsulated tin-coated aluminum lugs CPTAR are designed for connecting aluminum conductors to aluminum and copper busbars of distribution network up to 1 kV.



No.	Cable cross-section (mm ²)	Code	Type	Dimensions (mm)					Die	Packing				Barcode
				b	d	d1	d2	L		Product weight (g)	Bag packing (pcs)	Box packing (pcs)	Box BRUTO weight (kg)	
1	16	P40-58-01	CPTAR 16	20	10,5	5,5	16,5	75	E140	19,70	100	500	10,34	 8605031037142
2	25	P40-58-02	CPTAR 25	20	10,5	6,5	16,5	75	E140	19,10	100	500	10,04	 8605031037159
3	35	P40-58-03	CPTAR 35	25	12,8	8	20	94	E173	41,60	50	250	10,89	 8605031037166
4	50	P40-58-04	CPTAR 50	25	12,8	9	20	94	E173	37,20	50	250	9,79	 8605031037173
5	54	P40-58-05	CPTAR 54	25	12,8	10,5	20	94	E173	35,80	50	250	9,44	 8605031037180
6	70	P40-58-06	CPTAR 70	25	12,8	10,5	20	94	E173	35,80	50	250	9,44	 8605031037197
7	95	P40-58-07	CPTAR 95	25	12,8	12,2	20	94	E173	34,40	50	250	9,09	 8605031037203
8	120	P40-58-08	CPTAR 120	30	17	14,2	25	124	E215	75,31	25	150	11,79	 8605031037210
9	150	P40-58-09	CPTAR 150	30	17	15,5	25	124	E215	74,90	25	150	11,73	 8605031037227

Other characteristics

- Body material:** Weather and UV resistant Polyamide / Aluminum alloy – tin coated
- Rubber cap:** Weather and UV resistant Elastomer
- Conductive grease:** High conductivity grease
- Required tools:** Hydraulic or pneumatic press with appropriate inserts (Dies)
- Marking:** Plamen, cable cross-section, type, die, length of insulation stripping from the conductor, number of pressing, date
- Standard:** EN 50483-4, NFC 33-021

