

ALUMINUM-COPPER LUGS  
КАБЕЛЬНЫЕ НАКОНЕЧНИКИ АLCU  
COSSES ALUMINIUM-CUIVRE

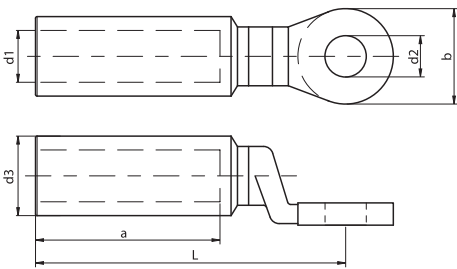

MATERIAL: Al, Cu  
STANDARD: SRPS N.F4.101  
МАТЕРИАЛ: Al, Cu  
СТАНДАРТ: SRPS N.F4.101  
MATÉRIEL: Al, Cu  
STANDARD: SRPS N.F4.101



No. п/п N. Ord.	Cable cross-section Сечение провода Section	Code Код (номер) Code	Type Тип Type	Dimension (mm) Размер (мм) Dimensions (mm)						Num.of pressmark* Номер опрессовки* Nombre de les sertissages*	Packing Упаковка Emballage	Weight Вес Poids
				a	b	d1	d2	d3	L			
1	16	P40-55-31	AlCu 16/6 S	20	13	5.8	6.4	12.0	48	4 / 2	100/500	27.10
2	16	P40-55-01	AlCu 16/8 S	20	13	5.8	8.4	12.0	48	4 / 2	100/500	26.72
3	16	P40-55-32	AlCu 16/10 S	20	17	5.8	10.5	11.0	48	4 / 2	100/500	26.30
4	25	P40-55-02	AlCu 25/8 S	35	16	6.8	8.4	12.0	63.5	4 / 2	100/500	25.63
5	25	P40-55-33	AlCu 25/10 S	35	17	6.8	10.5	12.0	63.5	4 / 2	100/500	31.53
6	25	P40-55-34	AlCu 25/12 S	35	19	6.8	13	12.0	63.5	4 / 2	100/500	33.31
7	35	P40-55-03	AlCu 35/8 S	42.5	17	8.0	8.4	14.0	72	5 / 3	100/500	33.28
8	35	P40-55-30	AlCu 35/10 S	42.5	19	8.0	10.5	14.0	72	5 / 3	100/500	34.25
9	35	P40-55-35	AlCu 35/12 S	42.5	21	8.0	13	14.0	72	5 / 3	100/500	35.67
10	50	P40-55-04	AlCu 50/8 S	42.5	20	9.8	8.4	16.0	91	5 / 3	100/500	61.64
11	50	P40-55-36	AlCu 50/10 S	42.5	22	9.8	10.5	16.0	91	5 / 3	100/500	60.05
12	50	P40-55-37	AlCu 50/12 S	42.5	24	9.8	13	16.0	91	5 / 3	100/500	50.85
13	50	P40-55-38	AlCu 50/16 S	42.5	28	9.8	17	16.0	91	5 / 3	100/500	63.47
14	70	P40-55-05	AlCu 70/8 S	52.5	24	11.2	8.4	18.5	101.5	6 / 3	50/250	78.67
15	70	P40-55-39	AlCu 70/10 S	52.5	24	11.2	10.5	18.5	101.5	6 / 3	50/250	51.00
16	70	P40-55-23	AlCu 70/12 S	52.5	24	11.2	13	18.5	101.5	6 / 3	50/250	58.38
17	70	P40-55-40	AlCu 70/16 S	52.5	30	11.2	17	18.5	101.5	6 / 3	50/250	100.00
18	95	P40-55-41	AlCu 95/10 S	52.5	28	13.2	10.5	22.0	102.5	6 / 3	50/250	127.40
19	95	P40-55-06	AlCu 95/12 S	52.5	28	13.2	13	22.0	102.5	6 / 3	50/250	106.67
20	95	P40-55-42	AlCu 95/16 S	52.5	32	13.2	17	22.0	102.5	6 / 3	50/250	108.50
21	120	P40-55-43	AlCu 120/10 S	52.5	32	14.7	10.5	23.0	115.5	6 / 3	50/250	139.72
22	120	P40-55-08	AlCu 120/12 S	52.5	32	14.7	13	23.0	115.5	6 / 3	50/250	157.21
23	120	P40-55-44	AlCu 120/16 S	52.5	32	14.7	17	23.0	115.5	6 / 3	50/250	120.23
24	120	P40-55-45	AlCu 120/20 S	52.5	38	14.7	21	23.0	115.5	6 / 3	50/250	122.35
25	150	P40-55-46	AlCu 150/10 S	62.5	34	16.3	10.5	25.0	126.5	7 / 3	25/150	135.75
26	150	P40-55-10	AlCu 150/12 S	62.5	34	16.3	13	25.0	126.5	7 / 3	25/150	135.00
27	150	P40-55-47	AlCu 150/16 S	62.5	34	16.3	17	25.0	126.5	7 / 3	25/150	128.80
28	150	P40-55-48	AlCu 150/20 S	62.5	40	16.3	21	25.0	126.5	7 / 3	25/150	125.50
29	185	P40-55-49	AlCu 185/10 S	62.5	37	18.3	10.5	28.5	134	7 / 3	25/100	268.00
30	185	P40-55-12	AlCu 185/12 S	62.5	37	18.3	13	28.5	134	7 / 3	25/100	263.00
31	185	P40-55-50	AlCu 185/16 S	62.5	37	18.3	17	28.5	134	7 / 3	25/100	260.50
32	185	P40-55-51	AlCu 185/20 S	62.5	40	18.3	21	28.5	134	7 / 3	25/100	257.30
33	240	P40-55-14	AlCu 240/12 S	72.5	42	21.0	13	32.0	145	8 / 3	25/100	261.25
34	240	P40-55-52	AlCu 240/16 S	72.5	42	21.0	17	32.0	145	8 / 3	25/100	262.00
35	240	P40-55-53	AlCu 240/20 S	72.5	45	21.0	21	32.0	145	8 / 3	25/100	268.00
36	300	P40-55-58	AlCu 300/12 S	70	40	23.3	13	34	123.5	8 / 3	10/50	412.00
37	300	P40-55-59	AlCu 300/16 S	70	40	23.3	17	34	123.5	8 / 3	10/50	408.00
38	300	P40-55-60	AlCu 300/20 S	70	40	23.3	19	34	123.5	8 / 3	10/50	402.00
39	400	P40-55-61	AlCu 400/12 S	75	45	28	13	42	145	- / 4	10/50	480.00
40	400	P40-55-62	AlCu 400/16 S	75	45	28	17	42	145	- / 4	10/50	485.00
41	400	P40-55-63	AlCu 400/20 S	75	45	28	19	42	145	- / 4	10/50	489.00
42	500	P40-55-64	AlCu 500/12 S	80	45	29.3	13	47	174	- / 5	10/50	585.00
43	500	P40-55-57	AlCu 500/16 S	80	45	29.3	17	47	174	- / 5	10/50	590.00
44	500	P40-55-65	AlCu 500/20 S	80	45	29.3	19	47	174	- / 5	10/50	598.00

\* - Number of mechanical (manual) crimps/number of hydraulic crimps  
Количество механических (ручных) опрессовок / количество гидравлических опрессовок  
Le nombre des pressages mécaniques ( manuels ) / nombre des pressages hydrauliques